

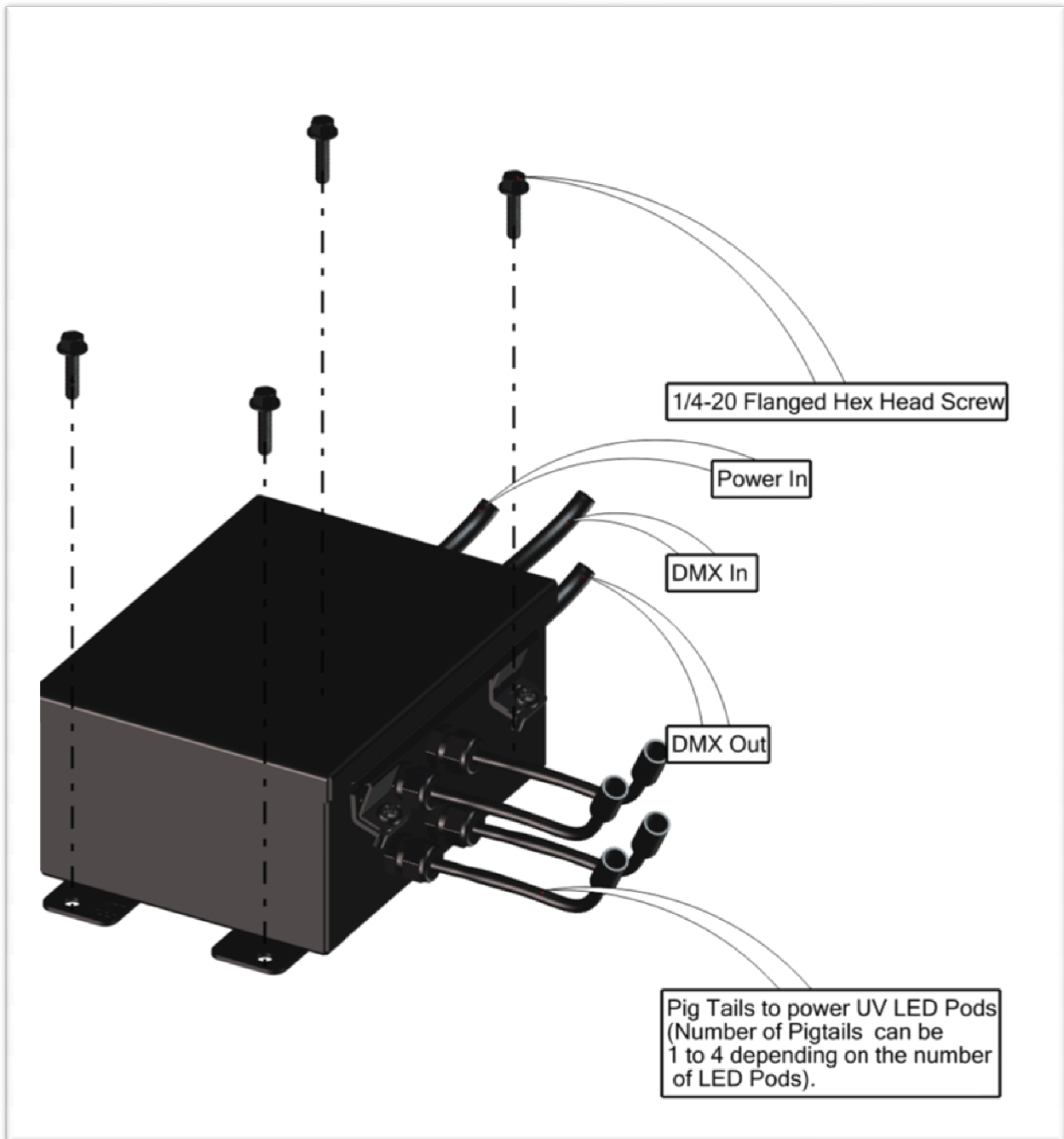

Outdoor LED UV fixture Installation Manual



Outdoor LED UV fixture Installation Instructions



Mount the Control Box in the desired location using suitable hardware.
1/4-20 screws are recommended for mounting the Control Box.

Other suitable means and hardware can be determined by the installer.

Connect the Power and Data with the provided Pigtails.

Outdoor LED UV fixture Installation Instructions

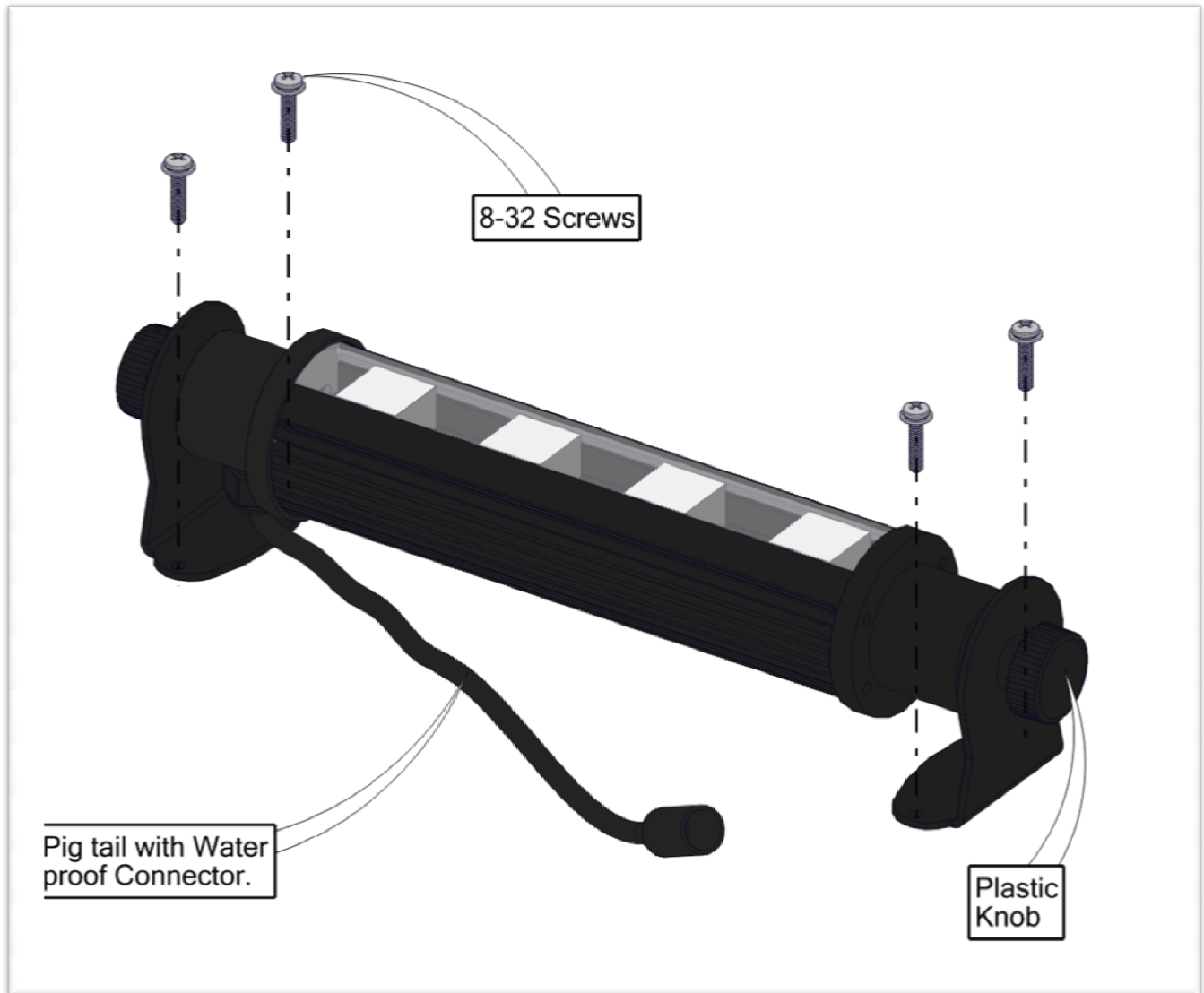

Mount the pods in the desired location using suitable hardware. 8-32 screws are recommended for installing the Pods.

Other suitable means and hardware can be determined by the installer.

The Pods can be mounted in any direction. The Pods can be set to any angle using the knobs on the both ends of the Pod.

Connect the Pods to the Control Box using the water proof connectors provided on the pigtails. For the Pods that are mounted more than 4 feet from the Control Box, use the Altman extension cables with the water proof connectors.