

Chalice 40 Down light

40W Color Changing LED Down light



The Chalice 40W Series is a compact 40 Watt IP44 rated & convection cooled fixture that is packed with a high feature set at an affordable price. This silent, compact luminaire weighs in at just 1.45pounds / 0.65kg. but features a powerful lumen output

The Chalice 40W Series down light from Altman Lighting is designed for permanent installation and energy savings. Offering all of the benefits and longevity of an LED luminaire, changing lamps in your fixtures has now become a thing of the past.

By incorporating industry standard DMX 512(RDM) control, the Chalice 40W Series is able to integrate seamlessly with an existing DMX RDM infrastructure and can be controlled by any DMX RDM supported lighting console.

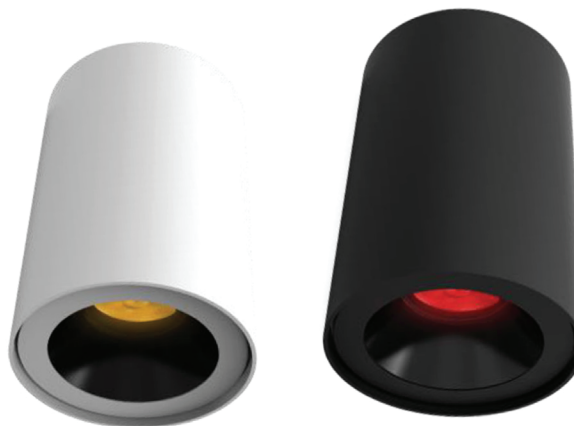

Product Features

- Available in four mounting options - Surface, Pendant, Wall, and Recessed Ceiling.
- 1050 max lumen
- IP44 rated for Damp Locations
- Lightweight - 1.45 lbs. (0.65kg) (Per Unit)
- Rotation (Pan) for Recessed Ceiling Installation: 360°
- Tilt Angle for Recessed Ceiling Installation: 30°
- Lens - 10°, 24°, 45°
- Optical Lens - Frost, Linear and Hex Louver
- Pluggable Terminal Block for power and data connection
- Compatible with DMX 512A(RDM) E1.20/ E.1.37.1 and .2 compliant
- LED Array
 - RGBACL(Red, Green, Blue, Amber, Cyan and Lime)
 - RGBL (Red, Green, Blue, Lime)
- Eight different control settings of:
 - 16-bit - 6 Color and Intensity (14 DMX Channels)
 - 16-bit - 4 Color and Intensity (10 DMX Channels)
 - 8-bit - 6 Color and Intensity (7 DMX Channels)
 - 8-bit - 4 Color and Intensity (5 DMX Channels)
 - HSIC (4 DMX Channels)
 - CCT (4 DMX Channels)
- Silent convection cooling
- External Power / Data Supply (Single, 2 Way and 8 way Available)
- Available in Black / White / Custom
- cETLus listed CE marked (PENDING)
- Five (5) year and one (1) day warranty
- No cost technical support for the life of your product

Chalice 40 Down light

40W Color Changing LED Down light



Photometric

Chalice 40W Series RGBACL

Output Setting	Beam Angle		Candela		Lumens	
Full On	10°		35550		850	
Throw Distance	10ft (3m)	15ft (4.6m)	20ft (6.1m)	25ft (7.62m)	30ft (9.14m)	40ft (12.19m)
Beam Diameter	1.8ft (0.5m)	2.6ft (0.8m)	3.5ft (1.0m)	4.3ft (1.3m)	5.2ft (1.5m)	7ft (2.1m)
Illuminance (fc) at Full On	132	58.8	33.1	21.2	14.7	8.3
Illuminance (lux) at Full On	1423	632.4	355.8	227.7	158.1	88.9

Note: To Calculate the Beam Diameter with the Fixture, Multiply any distance by 0.173

Chalice 40 RGBACL at 36° Degree Beam Angle									
Color	Full	Red	Green	Blue	Amber	Cyan	Lime	3200K	5600K
Illuminance (fc) at 10ft (3m)	28	2.9	6.5	1.6	12.8	2.7	28.1	19.0	25.5
Illuminance (lux) at 10ft (3m)	305	31.5	70.3	17.3	138	30.1	303	205	275

Chalice 40 RGBACL at 40° Degree Beam Angle									
Color	Full	Red	Green	Blue	Amber	Cyan	Lime	3200K	5600K
Illuminance (fc) at 10ft (3m)	17.9	1.8	4.0	1.0	8.1	1.7	17.8	12.0	16.0
Illuminance (lux) at 10ft (3m)	193	20	44.1	10.9	87.2	18.8	192	130	173

Chalice 40 RGBACL at 45° Degree Beam Angle									
Color	Full	Red	Green	Blue	Amber	Cyan	Lime	3200K	5600K
Illuminance (fc) at 10ft (3m)	11.2	1.1	2.5	0.6	5.0	1.0	11.0	7.5	10.0
Illuminance (lux) at 10ft (3m)	121	12.6	27.4	6.6	54.4	11.6	119	81	108

Parameter	Value
CCT	7057 K
Duv	0.0050
CRI(Ra)	95
Re(R1~R15)	93
CQS	93
TLCI(Qa)	96.9
GAI	98.9
TM-30-15 Rf	92
TM-30-15 Rg	100

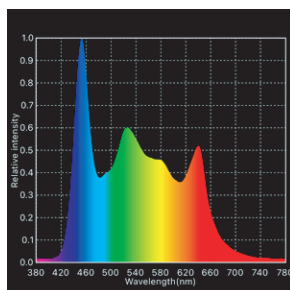
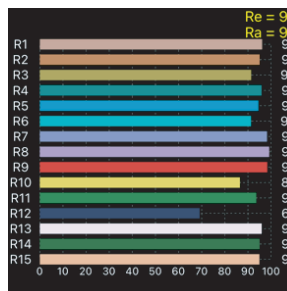
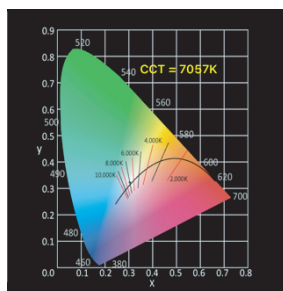

Chalice 40 Down light

40W Color Changing LED Down light



Photometric

Chalice 40W Series RGBL

Output Setting	Beam Angle	Candela	Lumens
Full On	10°	43915	1050

Note: To Calculate the Beam Diameter with the Fixture, Multiply any distance by 0.173

Throw Distance	10ft (3m)	15ft (4.6m)	20ft (6.1m)	25ft (7.62m)	30ft (9.14m)	40ft (12.19m)
Beam Diameter	1.8ft (0.5m)	2.6ft (0.8m)	3.5ft (1.0m)	4.3ft (1.3m)	5.2ft (1.5m)	7ft (2.1m)
Illuminance (fc) at Full On	159	70.5	39.7	25.4	17.6	9.9
Illuminance (lux) at Full On	1708	759.1	427	273.3	198	106.8

Chalice 40 RGBL at 36° Degree Beam Angle							
Color	Full	Red	Green	Blue	Lime	3200K	5600K
Illuminance (fc) at 10ft (3m)	34.6	4.47	12.5	2.3	17.3	22.6	29.3
Illuminance (lux) at 10ft (3m)	373.2	48.2	135	25.5	186.7	243.4	316.3

Chalice 40 RGBL at 40° Degree Beam Angle							
Color	Full	Red	Green	Blue	Lime	3200K	5600K
Illuminance (fc) at 10ft (3m)	20.8	2.5	7.5	1.6	10.5	13.6	17.3
Illuminance (lux) at 10ft (3m)	224.5	27.4	81.7	17.9	113.2	146.7	186.6

Chalice 40 RGBL at 45° Degree Beam Angle							
Color	Full	Red	Green	Blue	Lime	3200K	5600K
Illuminance (fc) at 10ft (3m)	12.7	1.6	4.7	0.7	6.4	8.43	10.7
Illuminance (lux) at 10ft (3m)	136.8	17.3	50.7	8.5	69.9	90.8	115.5

Parameter	Value
CCT	23507 K
Duv	0.0035
CRI(Ra)	87
Re(R1~R15)	80
CQS	87
TLCI(Qa)	81.1
GAI	113.1
TM-30-15 Rf	83
TM-30-15 Rg	102

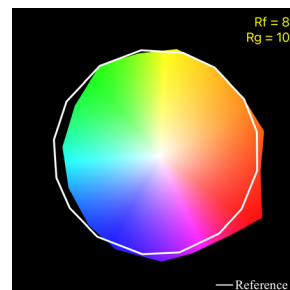
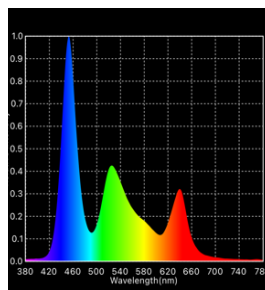
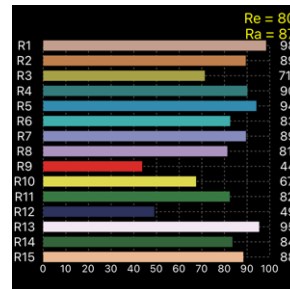
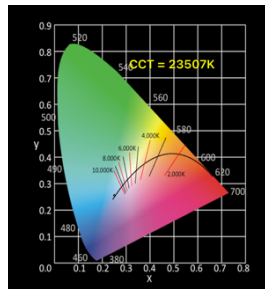

Chalice 40 Down light

40W Color Changing LED Down light



Dimensions / Mounting

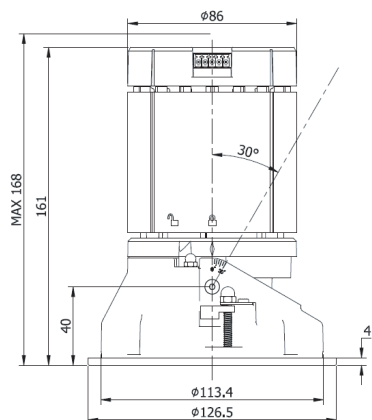

Chalice 40 Dimensions

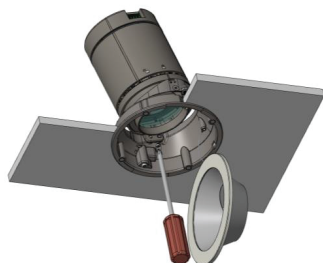

Recessed Ceiling Mount



Wall Mount



Surface / Pendant Mount

Note: All Dimensions are in Millimeters .

Note: Chalice 40 series is designed for easy ceiling mount installation. The two wind down clamps cater to ceiling thicknesses from 0.07in to 0.78in (2 to 20 mm).

DMX Map

DMX CH	16 Bit - RGBACL*	8bit - RGBACL*	16 Bit - RGBL*	8bit - RGBL*	RGBACL - Direct	RGBL - Direct	16bit - RGB	8bit - RGB	HSI	CCT	CFX
1	Intensity High	Intensity	Intensity High	Intensity	Red	Red	Intensity High	Intensity	Intensity	Intensity	Intensity
2	Intensity Low	Red	Intensity Low	Red	Green	Green	Intensity Low	Red	Hue High	CCT Presets	Color Filter
3	Red High	Green	Red High	Green	Blue	Blue	Red High	Green	Hue Low	CCT exact value	Motion Color
4	Red Low	Blue	Red Low	Blue	Amber	Lime	Red Low	Blue	Saturation	Tint (Greenly)	Fade time
5	Green High	Amber	Green High	Lime	Cyan		Green High				Color Hold
6	Green Low	Cyan	Green Low		Lime		Green Low				
7	Blue High	Lime	Blue High				Blue High				
8	Blue Low		Blue Low				Blue Low				
9	Amber High		Lime High								
10	Amber Low		Lime Low								
11	Cyan High										
12	Cyan Low										
13	Lime High										
14	Lime Low										

Note: * Certain modes will only work with certain Chalice 40 LED Engines

Power and Control Wiring

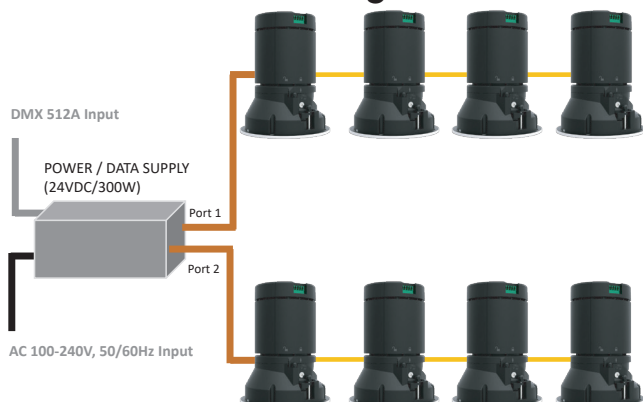

Chart below is base on 16awg Power Cord for 2 Port Power Supply

Feed-In Cable	Number of Fixture Linking in series (Unit)	Length of power cord between fixture
16ft (5m)	4	13ft (4m)
32ft (10m)	4	16ft (5m)
49ft (15m)	4	32ft (10m)
32ft (10m)	3	65ft (20m)
65ft (20m)	3	32ft (10m)
82ft (25m)	3	16ft (5m)
98ft (30m)	2	98ft (30m)
131ft (40m)	2	32ft (10m)

Note: Max Number of Fixtures per run is 4 units

Chalice 40 Down light



40W Color Changing LED Down light

60W Power Supply Dimensions

Note: * Drawings are not to Scale

60W Power Supply:

- For a Single Fixture
- DMX and Power terminate in box
- Power Flying lead out to the Fixture

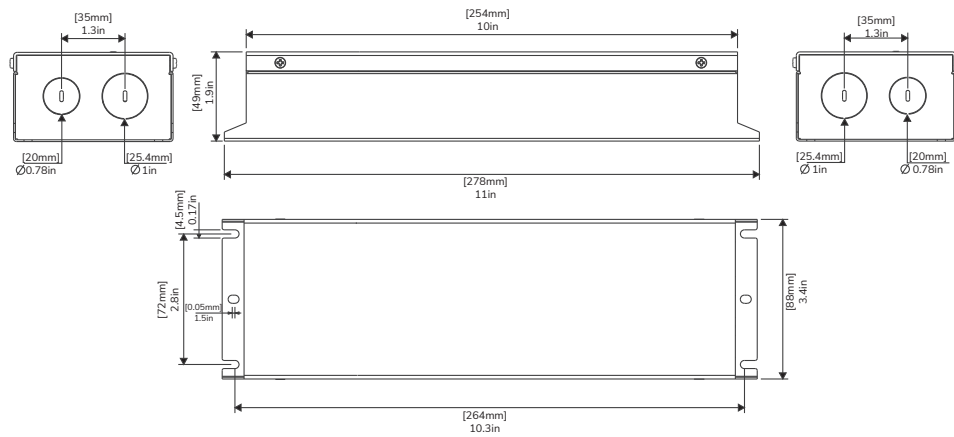

300W Power Supply Dimensions

300W Power Supply:

- 2 Ports (4 Fixtures Per Port*)
- LCD Screen for Programming
- DMX In / Thru
- Network Input

* Depends on length of the Power and Data Cable Run

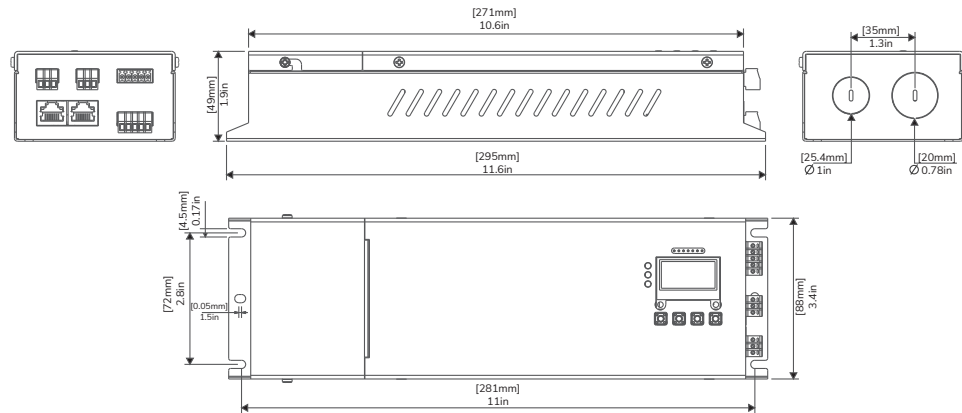

400W Power Supply Dimensions

400W Power Supply:

- 8 Input Ports (1 Fixtures Per Port)
- LCD Screen for Programming
- DMX In / Thru
- Network Input
- Panic Input
- 2 Expansions Ports (Each Port can have 4 additional Fixtures per Port)

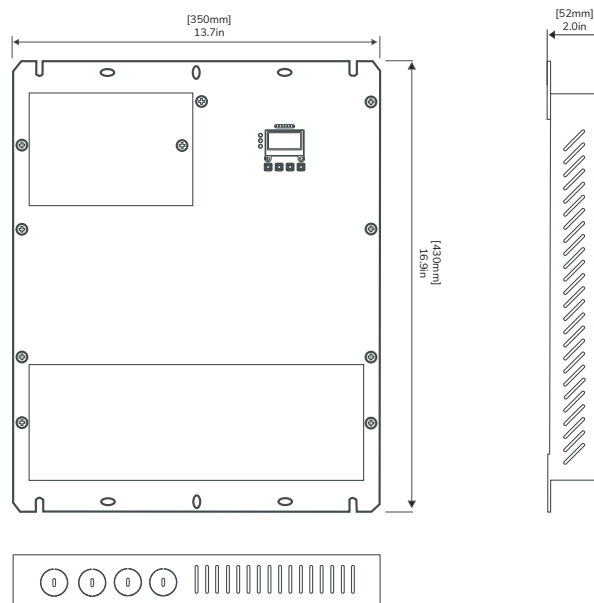

Altman Lighting - 1400 East 66th Avenue - Denver, CO 80229 USA

+1 303 500-7072 - customerservice@altmanlighting.com - sales@altmanlighting.com - support@altmanlighting.com

August 6th 2024 © 2024 Altman Stage Lighting, Inc.

All specifications, descriptions, information, design, etc. Contained in this document are subject to change without prior notice. All rights reserved.



Chalice 40 Down light

40W Color Changing LED Down light



Specifications

LED Source

LED Engine:	1X40 Watt RGBL / RGBACL
Max Power Consumption:	40 Watts per unit
Rated LED Life:	Arrays are rated for >50,000 to L70

Color

Color Used:	RGBL and RGBACL
Color Temperature Range:	1800K - 10000K
Dimming Curves:	Linear, Incandescent and Standard
Tungsten Dimming Simulation:	Off to 2500W
Color Calibration:	Yes (On and Off Setting)

Optical

Beam angle options:	10 degree (Narrow) 24 degree (Medium) 45 degree (Wide)
Optical filters:	Frosted - 5 Degree Narrow Linear - 1 x 35° Medium Linear - 10 x 40° Hex Louver
Trim Rings:	Standard Dark reflection Off set slot Wall Wash Pin Hole

Control and Programming

Input Connections:	DMX512 / RJ45
Protocols:	DMX512/RDM / Artnet and sACN
Modes:	16-bit - 6 Color (14 DMX Chan) 16-bit - 4 Color (10 DMX Chan) 8-bit - 6 Color (7 DMX Chan) 8-bit - 4 Color (5 DMX Chan) HSIC (4 DMX Channels) CCT (4 DMX Channels)
RDM Configuration:	Yes
User Interface:	Local User Interface on Power Supply. RDM used to Address Fixture
Presets:	60 Preset Colors

Electrical

Voltage Range:	100-240 VAC, 50/60 Hz
Wattage:	60w - Single Fixture 300w - 2 Port Power Supply 400w - 8 Input Power Supply

Thermal

Operating Conditions:	Temperature: 10°C to 40°C (50°F to °104F) with humidity up to 95% (non-condensing)
Damp Location and Recessed Fixture Requirements:*	Airflow within the upper ceiling should maintain a humidity level not exceeding 70%.
Fan:	Convection cooled, Fan free, silent operation

Construction

Materials:	Extruded aluminum, sheet metal and Die Cast aluminum
Color Options:	Black, White or Custom
Mounting:	Ceiling, Pendant, Wall
Ceiling Mount Thickness Recessed Unit:	0.07in to 0.78in (2mm to 20mm)
IP Rating:	IP44
Included Accessories:	TBD

Warranty

Fixture:	5 Years and 1 Day.
Support:	Forever the life of the Product

Compliance

Compliance Marks:	cETLus listed CE marked (Pending)
Country of Origin:	Assembled in the USA

* Note: Every Chalice 40 will have a Waterproof Rubber / Silicone Rubber ring that is pre-installed on the ceiling mounting ring.

* Each unit will have a Transparent PC Lens on the Trim ring with waterproof tape.

Chalice 40 Down light

40W Color Changing LED Down light



Ordering Information

Models

Model:	Mounting Kits	Lenses	LED:	Body Color:
ACD40	PMK-Pendant STEM-72-Stem PMK SMK-Surface WMK-Wall	ACD40-FL-Frosted ACD40-LL-Linear ACD40-LVR- Louver ACD40-DR-Dark Reflector	RGBACL - Color Mixing RGBL - Color Mixing	B - Black W- White C - Custom

Note: When ordering the fixture simply select an option from each column and that will produce your ordering part number .

Color: Fixture ship standard as Black or White. If Custom is required that could result in a longer lead time.

Trim Plate Accessories



Wall Wash Trim Plate:
ACD40-WW



Dark Reflector Trim Plate:
ACD40-DR



Off-Set Trim Plate:
ACD40-OSS



Pinhole Trim Plate:
ACD40-PH

Note: Fixture ships with a Dark Reflector Trim Plate.

* - When ordering Trim Plate simply use B - Black, W -White and C - Custom.

Trim Plate Color: Fixture ship standard as Black or White. If Custom is required that could result in a longer lead time.

Optical Accessories



Frosted 5 Degree Lens:
ACD40-FL



Medium Linear Lens - 10 x 40°:
ACD40-LL



Hex Louver Lens:
ACD40-LVR

Note: All Optical Accessories are sold separately.

Power Supplies

Model:	Description:
ADP-60	60W Power Supply - Single Fixture
ADP-300	300W Power Supply - 2 Port (4 Fixture Per Port)
ADP-400	400W Power Supply - 8 Fixtures with 2 Expansion Ports

Accessories

Model:	Description:
510	Malleable Iron Clamp
515	Extruded Aluminum C-Clamp
SC-36-BK	36-Inch Black Safety Cable with Spring Clip
SS-SC-40-BK	40-Inch Stainless Steel Safety Cable with Spring Clip
61-DMXCAT	DMXCAT DMX / RDM Setup Tool