

Aurora 40 Down Light

40W Color Changing LED Down Light



The Aurora 40W Series is a compact 40 Watt IP44 rated & convection cooled fixture that is packed with a high feature set at an affordable price. This silent, compact luminaire weighs in at just 1.45pounds / 0.65kg. but features a powerful lumen output

The Aurora 40W Series down light from Altman Lighting is designed for permanent installation and energy savings. Offering all of the benefits and longevity of an LED luminaire, changing lamps in your fixtures has now become a thing of the past.

By incorporating industry standard DMX 512(RDM) control, the Aurora 40W Series is able to integrate seamlessly with an existing DMX RDM infrastructure and can be controlled by any DMX RDM supported lighting console.



Bringing Imagination to Light™

Product Features

- Available in four mounting options - Surface, Pendant, Wall, and Recessed Ceiling.
- 1050 max lumen
- IP44 rated for Damp Locations
- Lightweight - 1.45 lbs. (0.65kg) (Per Unit)
- Rotation (Pan) for Recessed Ceiling Installation: 360°
- Tilt Angle for Recessed Ceiling Installation: 30°
- Lens - 10°, 24°, 45°
- Optical Lens - Frost, Linear and Hex Louver
- Pluggable Terminal Block for power and data connection
- Compatible with DMX 512A(RDM) E1.20/ E.1.37.1 and .2 compliant
- LED Array
 - RGBACL(Red, Green, Blue, Amber, Cyan and Lime)
 - RGBL (Red, Green, Blue, Lime)
- Eight different control settings of:
 - 16-bit - 6 Color and Intensity (14 DMX Channels)
 - 16-bit - 4 Color and Intensity (10 DMX Channels)
 - 8-bit - 6 Color and Intensity (7 DMX Channels)
 - 8-bit - 4 Color and Intensity (5 DMX Channels)
 - HSIC (4 DMX Channels)
 - CCT (4 DMX Channels)
- Silent convection cooling
- External Power / Data Supply (Single, 2 Way and 8 way Available)
- Available in Black / White / Custom
- cETLus listed CE marked (PENDING)
- Five (5) year and one (1) day warranty
- No cost technical support for the life of your product



Aurora 40 Down Light

40W Color Changing LED Down Light



Photometrics

Chalice 40W Series RGBACL

Output Setting	Beam Angle	Candela	Lumens
Full On	10°	35550	850

Note: To Calculate the Beam Diameter with the Fixture, Multiply any distance by 0.173

Throw Distance	10ft (3m)	15ft (4.6m)	20ft (6.1m)	25ft (7.62m)	30ft (9.14m)	40ft (12.19m)
Beam Diameter	1.8ft (0.5m)	2.6ft (0.8m)	3.5ft (1.0m)	4.3ft (1.3m)	5.2ft (1.5m)	7ft (2.1m)
Illuminance (fc) at Full On	132	58.8	33.1	21.2	14.7	8.3
Illuminance (lux) at Full On	1423	632.4	355.8	227.7	158.1	88.9

Chalice 40 RGBACL at 36° Degree Beam Angle									
Color	Full	Red	Green	Blue	Amber	Cyan	Lime	3200K	5600K
Illuminance (fc) at 10ft (3m)	28	2.9	6.5	1.6	12.8	2.7	28.1	19.0	25.5
Illuminance (lux) at 10ft (3m)	305	31.5	70.3	17.3	138	30.1	303	205	275

Chalice 40 RGBACL at 40° Degree Beam Angle									
Color	Full	Red	Green	Blue	Amber	Cyan	Lime	3200K	5600K
Illuminance (fc) at 10ft (3m)	17.9	1.8	4.0	1.0	8.1	1.7	17.8	12.0	16.0
Illuminance (lux) at 10ft (3m)	193	20	44.1	10.9	87.2	18.8	192	130	173

Chalice 40 RGBACL at 45° Degree Beam Angle									
Color	Full	Red	Green	Blue	Amber	Cyan	Lime	3200K	5600K
Illuminance (fc) at 10ft (3m)	11.2	1.1	2.5	0.6	5.0	1.0	11.0	7.5	10.0
Illuminance (lux) at 10ft (3m)	121	12.6	27.4	6.6	54.4	11.6	119	81	108

Parameter	Value
CCT	7057 K
Duv	0.0050
CRI(Ra)	95
Re(R1~R15)	93
CQS	93
TLCI(Qa)	96.9
GAI	98.9
TM-30-15 Rf	92
TM-30-15 Rg	100

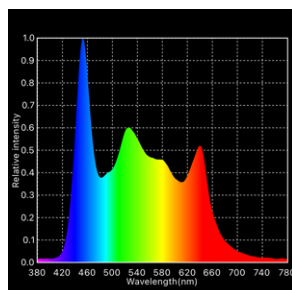
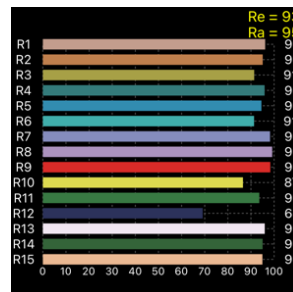
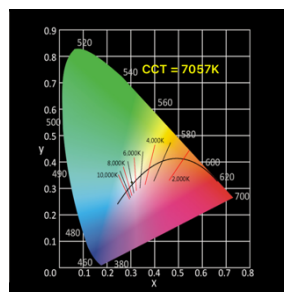

Aurora 40 Down Light

40W Color Changing LED Down Light



Photometrics

Chalice 40W Series RGBL

Output Setting	Beam Angle	Candela	Lumens
Full On	10°	43915	1050

Note: To Calculate the Beam Diameter with the Fixture, Multiply any distance by 0.173

Throw Distance	10ft (3m)	15ft (4.6m)	20ft (6.1m)	25ft (7.62m)	30ft (9.14m)	40ft (12.19m)
Beam Diameter	1.8ft (0.5m)	2.6ft (0.8m)	3.5ft (1.0m)	4.3ft (1.3m)	5.2ft(1.5m)	7ft (2.1m)
Illuminance (fc) at Full On	159	70.5	39.7	25.4	17.6	9.9
Illuminance (lux) at Full On	1708	759.1	427	273.3	198	106.8

Chalice 40 RGBL at 36° Degree Beam Angle							
Color	Full	Red	Green	Blue	Lime	3200K	5600K
Illuminance (fc) at 10ft (3m)	34.6	4.47	12.5	2.3	17.3	22.6	29.3
Illuminance (lux) at 10ft (3m)	373.2	48.2	135	25.5	186.7	243.4	316.3

Chalice 40 RGBL at 40° Degree Beam Angle							
Color	Full	Red	Green	Blue	Lime	3200K	5600K
Illuminance (fc) at 10ft (3m)	20.8	2.5	7.5	1.6	10.5	13.6	17.3
Illuminance (lux) at 10ft (3m)	224.5	27.4	81.7	17.9	113.2	146.7	186.6

Chalice 40 RGBL at 45° Degree Beam Angle							
Color	Full	Red	Green	Blue	Lime	3200K	5600K
Illuminance (fc) at 10ft (3m)	12.7	1.6	4.7	0.7	6.4	8.43	10.7
Illuminance (lux) at 10ft (3m)	136.8	17.3	50.7	8.5	69.9	90.8	115.5

Parameter	Value
CCT	23507 K
Duv	0.0035
CRI(Ra)	87
Re(R1~R15)	80
CQS	87
TLCI(Qa)	81.1
GAI	113.1
TM-30-15 Rf	83
TM-30-15 Rg	102

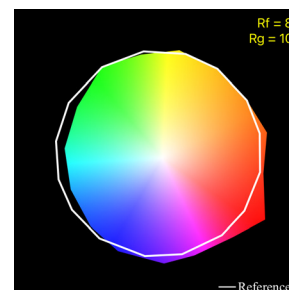
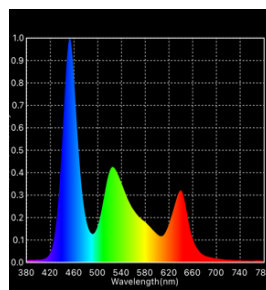
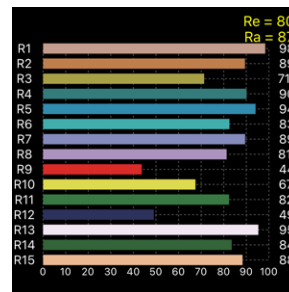
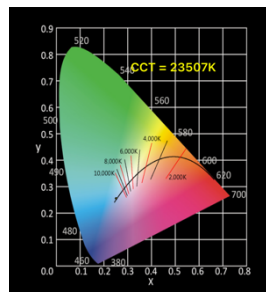

Aurora 40 Down Light

40W Color Changing LED Down Light



Dimensions / Mounting

Note: All Dimensions are in Millimeters .

Note: Aurora 40 series is designed for easy ceiling mount installation. The two wind down clamps cater to ceiling thicknesses from 0.07in to 0.78in (2 to 20 mm). All mounting accessories are sold separately.

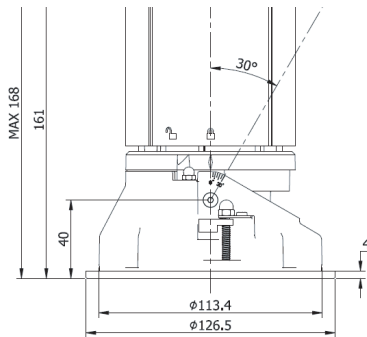

Chalice 40 Dimensions

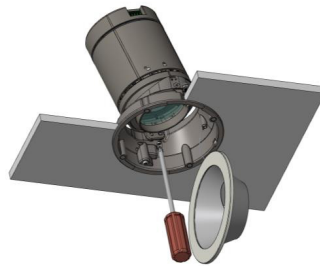

Recessed Ceiling Mount



Wall Mount



Surface / Pendant Mount

DMX Map

DMX CH	16 Bit - RGBACL*	8bit - RGBACL*	16 Bit - RGBL*	8bit - RGBL*	RGBACL - Direct	RGBL - Direct	16bit - RGB	8bit - RGB	HSI	CCT	CFX
1	Intensity High	Intensity	Intensity High	Intensity	Red	Red	Intensity High	Intensity	Intensity	Intensity	Intensity
2	Intensity Low	Red	Intensity Low	Red	Green	Green	Intensity Low	Red	Hue High	CCT Presets	Color Filter
3	Red High	Green	Red High	Green	Blue	Blue	Red High	Green	Hue Low	CCT exact value	Motion Color
4	Red Low	Blue	Red Low	Blue	Amber	Lime	Red Low	Blue	Saturation	Tint (Greenly)	Fade time
5	Green High	Amber	Green High	Lime	Cyan		Green High				Color Hold
6	Green Low	Cyan	Green Low		Lime		Green Low				
7	Blue High	Lime	Blue High				Blue High				
8	Blue Low		Blue Low				Blue Low				
9	Amber High		Lime High								
10	Amber Low		Lime Low								
11	Cyan High										
12	Cyan Low										
13	Lime High										
14	Lime Low										

Note: * Certain modes will only work with certain Chalice 40 LED Engines

Power and Control Wiring

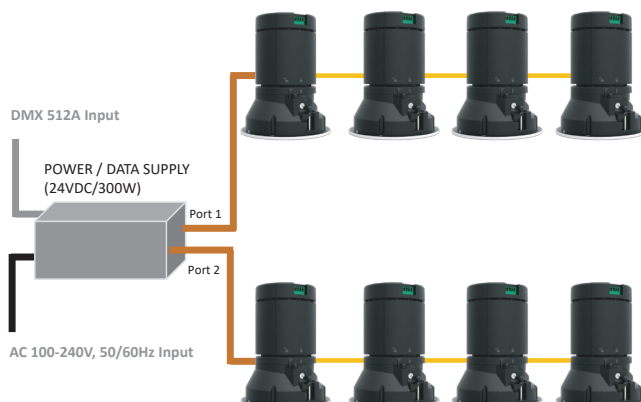

Chart below is base on 16awg Power Cord for 2 Port Power Supply

Feed-In Cable	Number of Fixture Linking in series (Unit)	Length of power cord between fixture
16ft (5m)	4	13ft (4m)
32ft (10m)	4	16ft (5m)
49ft (15m)	4	32ft (10m)
32ft (10m)	3	65ft (20m)
65ft (20m)	3	32ft (10m)
82ft (25m)	3	16ft (5m)
98ft (30m)	2	98ft (30m)
131ft (40m)	2	32ft (10m)

Note: Max Number of Fixtures per run is 4 units

Aurora 40 Down Light

40W Color Changing LED Down Light



AURORA
BY ALTMAN

60W Power Supply Dimensions (ADP-60)

60W Power Supply:

- For a Single Fixture
- DMX and Power terminate in box
- Power Flying lead out to the Fixture

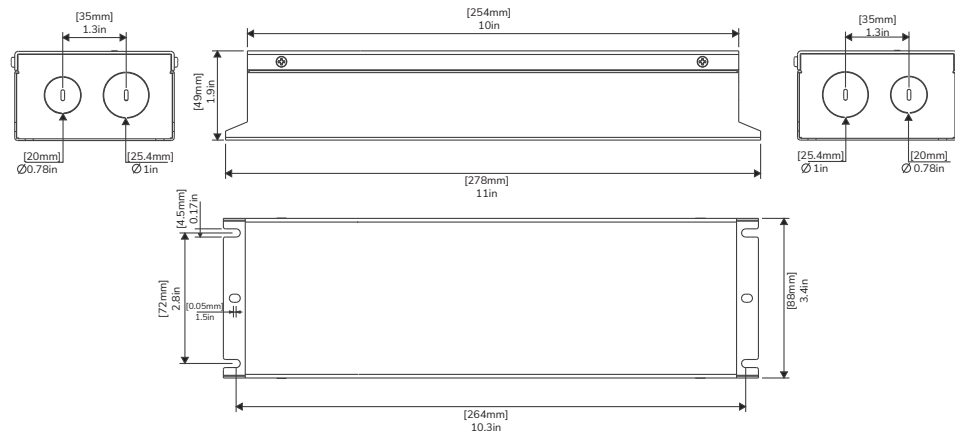

300W Power Supply Dimensions (ADP-300)

300W Power Supply:

- 2 Ports (4 Fixtures Per Port*)
- LCD Screen for Programming
- DMX In / Thru
- Network Input

* Depends on length of the Power and Data Cable Run

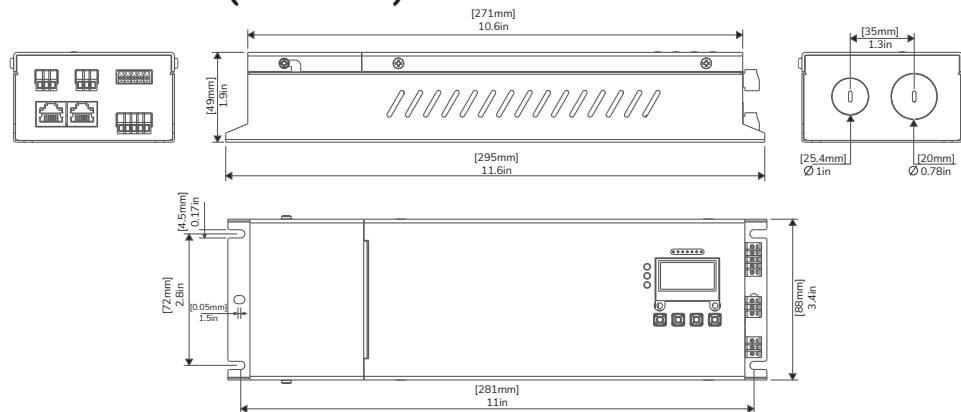

400W Power Supply Dimensions (ADP-400)

400W Power Supply:

- 8 Input Ports (1 Fixtures Per Port)
- LCD Screen for Programming
- DMX In / Thru
- Network Input
- Panic Input
- 2 Expansions Ports (Each Port can have 4 additional Fixtures per Port)

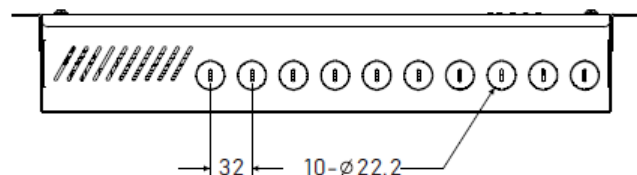
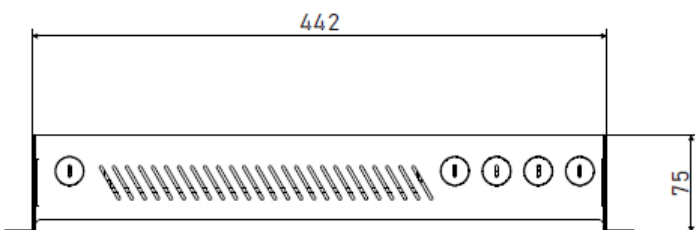
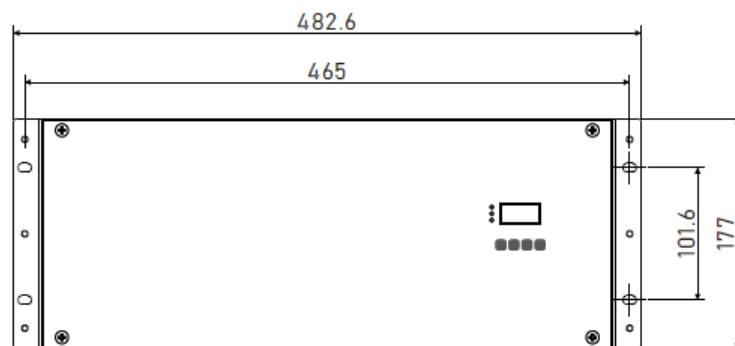

Aurora 40 Down Light

40W Color Changing LED Down Light



Specifications

LED Source

LED Engine:	1X40 Watt RGBL / RGBACL
Max Power Consumption:	40 Watts per unit
Rated LED Life:	Arrays are rated for >50,000 to L70

Color

Color Used:	RGBL and RGBACL
Color Temperature Range:	1800K - 10000K
Dimming Curves:	Linear, Incandescent and Standard
Tungsten Dimming Simulation:	Off to 2500W
Color Calibration:	Yes (On and Off Setting)

Optical

Beam angle options:	10 degree (Narrow) 24 degree (Medium) 45 degree (Wide)
Optical filters:	Frosted - 5 Degree Narrow Linear - 1 x 35° Medium Linear - 10 x 40° Hex Louver
Trim Rings:	Standard Dark reflection Off set slot Wall Wash Pin Hole

Control and Programming

Input Connections:	DMX512 / RJ45
Protocols:	DMX512/RDM / Artnet and sACN
Modes:	16-bit - 6 Color (14 DMX Chan) 16-bit - 4 Color (10 DMX Chan) 8-bit - 6 Color (7 DMX Chan) 8-bit - 4 Color (5 DMX Chan) HSIC (4 DMX Channels) CCT (4 DMX Channels)
RDM Configuration:	Yes
User Interface:	Local User Interface on Power Supply. RDM used to Address Fixture
Presets:	60 Preset Colors

Electrical

Voltage Range:	100-240 VAC, 50/60 Hz
Wattage:	60w - Single Fixture 300w - 2 Port Power Supply 400w - 8 Input Power Supply

Thermal

Operating Conditions:	Temperature: 10°C to 40°C (50°F to °104F) with humidity up to 95% (non-condensing)
Damp Location and Recessed Fixture Requirements:*	Airflow within the upper ceiling should maintain a humidity level not exceeding 70%.
Fan:	Convection cooled, Fan free, silent operation

Construction

Materials:	Extruded aluminum, sheet metal and Die Cast aluminum
Color Options:	Black, White or Custom
Mounting:	Ceiling, Pendant, Wall
Ceiling Mount Thickness Recessed Unit:	0.07in to 0.78in (2mm to 20mm)
IP Rating:	IP44
Included Accessories:	TBD

Warranty

Fixture:	5 Years and 1 Day.
Support:	Forever the life of the Product

Compliance

Compliance Marks:	cETLus listed CE marked (Pending)
Country of Origin:	Assembled in the USA

* Note: Every Aurora 40 will have a Waterproof Rubber / Silicone Rubber ring that is pre-installed on the ceiling mounting ring.

* Each unit will have a Transparent PC Lens on the Trim ring with waterproof tape.

Aurora 40 Down Light

40W Color Changing LED Down Light



Ordering Information

Models

Model:	Light Engine	Body Finish Color	Trim Ring Color	Control
ACD40	RGBACL RGBL	B - Black W - White C - Custom	B - Black W - White C - Custom	D-DMX

Trim Plate Accessories

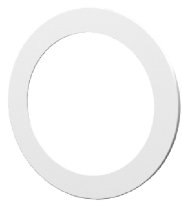

Standard
Ring



Dark
Reflector Ring



Wall Wash
Ring



Pinhole
Ring

Note: Fixture ships with a Standard Ring/Plate

* - When ordering Trim Plate simply use B - Black, W -White and C - Custom.

Trim Plate Color: Fixture ship standard as Black or White. If Custom is required that could result in a longer lead time.

Optical Accessories



Frosted 5 Degree Lens:
(ACD40-FL)



Linear Lens - 10 x 40°:
(ACD40-LL)



Hex Louver Lens:
(ACD40-LVR)

Note: All Optical Accessories are sold separately.

Power Supplies

Model:	Description:
ADP-60	60W Power Supply - Single Fixture
ADP-300	300W Power Supply - 2 Port (4 Fixture Per Port)
ADP-400	400W Power Supply - 8 Fixtures with 2 Expansion Ports

Accessories

Model:	Description:
ACD40-PMK	Pendant Mounting Kit
ACD40-WMK	Wall Mounting Kit
ACD40-SMK	Surface Mounting Kit
ACD-STEM-72	Additional 72" Stem Extension
E-box-4	4-Port Ethernet Hub



AURORA

BY ALTMAN



ALTMAN

Bringing Imagination to Light™

1400 East 66th Ave., Denver, CO 80229

www.altmanlighting.com

303-500-7072 www.altmanlighting.com sales@altmanlighting.com